

Brook

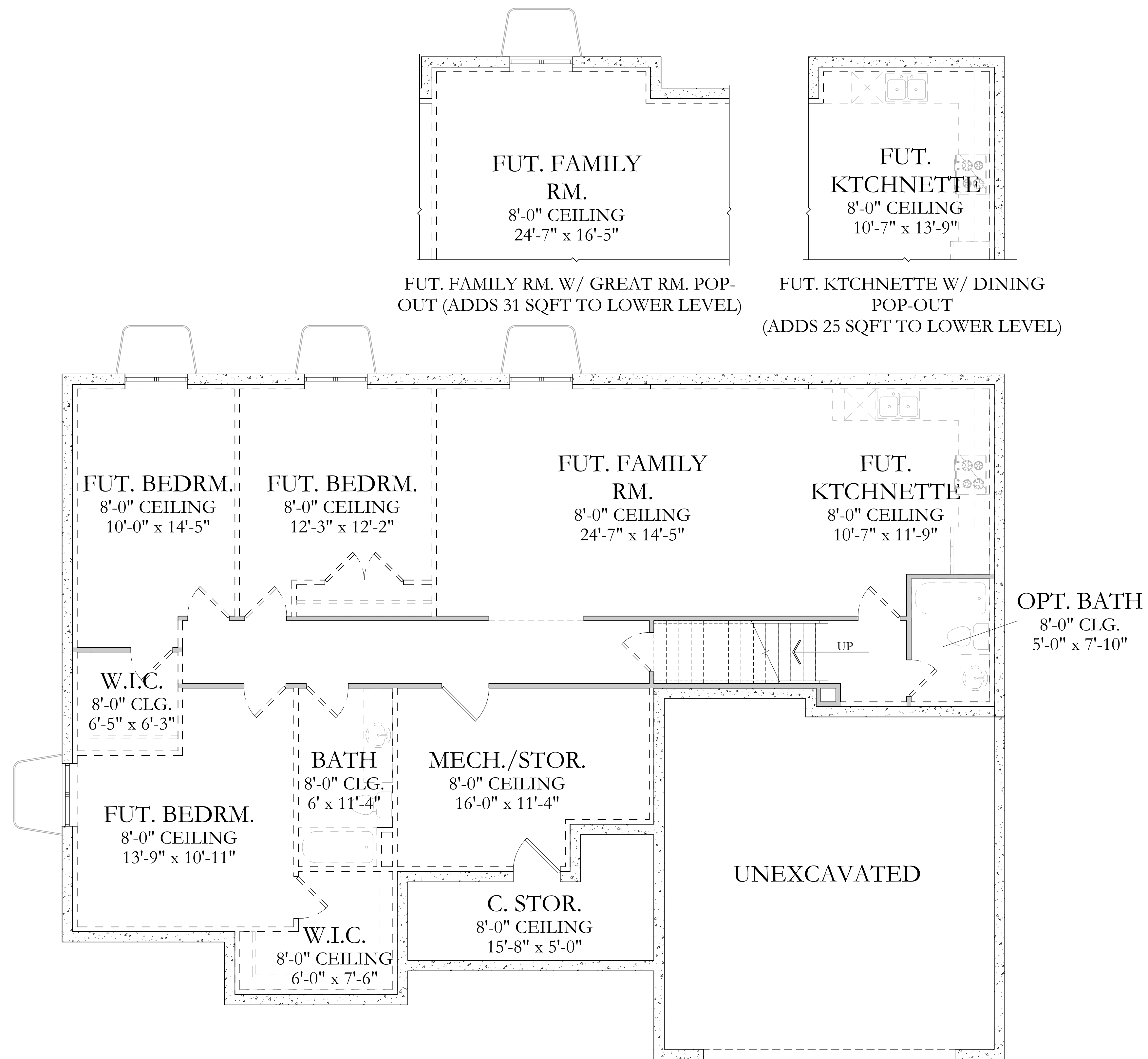

Square Footage:

BASEMENT:	1926 TO 1981 SQFT
MAIN FLOOR:	1807 TO 1863 SQFT
UPPER FLOOR:	

Total Square Footage:

TOTAL FINISHED:	1807 - 1863 SQFT
TOTAL:	3733 - 3844 SQFT
WIDTH:	60'-0" TO 71'-0"
DEPTH:	43'-8" TO 47'-8"

Disclosure: Home SQFT--both finished and unfinished--are approximate and are subject to change. Please see sales agent for further information.